

# SHIMANO

## BIG BAITRUNNER

## BIG-BTR-LC

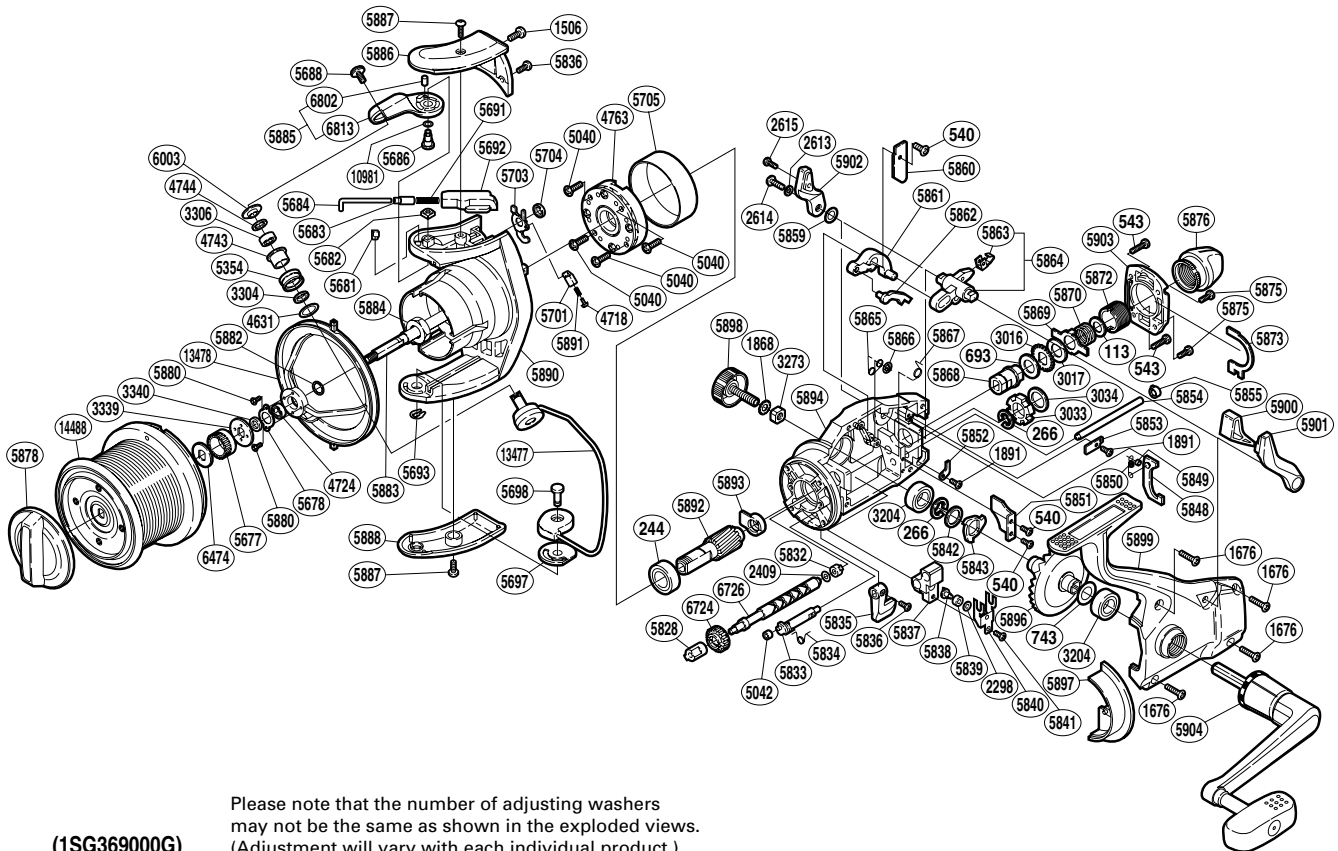

Please note that the number of adjusting washers may not be the same as shown in the exploded views. (Adjustment will vary with each individual product.)

(1SG369000G)

Part No.	Description	Part No.	Description	Part No.	Description
RD 0113	Tension Spring Washer (B)	RD 5686	Bail Arm Shaft	RD 5868	Free Spool Tension Shaft
RD 0244	Ball Bearing	RD 5688	Line Roller Screw	RD 5869	Eared Washer
RD 0266	"C" Lock	RD 5691	Bail Spring	RD 5870	Free Spool Tension Spring
RD 0540	Multi-Purpose Screw (A)	RD 5692	Bail Spring Guide (B)	RD 5872	Free Spool Tension Screw
RD 0543	Rear Protector Screw (long)	RD 5693	"U" Lock	RD 5873	Dial Retainer
RD 0693	Free Spool Tension Washer (cloth)	RD 5697	Bail Hold Support Spacer	RD 5875	Rear Protector Screw (short)
RD 0743	Drive Gear Washer	RD 5698	Bail Hold Support Shaft	RD 5876	BaitRunner Tension Dial
RD 1506	Bail Spring Cover Screw	RD 5701	Lever Spring Guide (B)	RD 5878	Drag Knob
RD 1676	Side Cover Screw	RD 5703	Bail Trip Lever	RD 5880	Bearing Retainer Screw
RD 1868	Handle Lock Washer	RD 5704	Trip Lever Spacer	RD 5882	Line Safety Guard Washer
RD 1891	Multi-Purpose Screw (C)	RD 5705	Roller Clutch Ring	RD 5883	Main Shaft
RD 2298	Spacer	RD 5828	Worm Bushing (front)	RD 5884	Rotor Nut
RD 2409	Worm Shaft Spacer	RD 5832	Worm Bushing (rear)	RD 5885	Bail Arm
RD 2613	Lock Washer	RD 5833	Anti-Reverse Cam	RD 5886	Bail Spring Cover
RD 2614	Clutch Arm Screw	RD 5834	Anti-Reverse Cam Spring	RD 5887	Multi-Purpose Screw (E)
RD 2615	BaitRunner Lever Screw	RD 5835	Anti-Reverse Lever	RD 5888	Bail Hold Support Guard
RD 3016	Click Gear	RD 5836	Multi-Purpose Screw (D)	RD 5890	Rotor
RD 3017	Free Spool Tension Washer (B)	RD 5837	Oscillating Slider	RD 5891	Bail Trip Lever Spring
RD 3033	BaitRunner Ratchet	RD 5838	Oscillating Pawl	RD 5892	Pinion Gear
RD 3034	Ratchet Spacer	RD 5839	Oscillating Slider Bushing	RD 5893	Pinion Bushing
RD 3204	Ball Bearing	RD 5840	Oscillating Slider Retainer	RD 5894	Body
RD 3273	Handle Screw Lock	RD 5841	Slider Retainer Screw	RD 5896	Drive Gear
RD 3304	Bearing Spacer	RD 5842	Drive Gear Ratchet Spacer	RD 5897	Side Cover Flange
RD 3306	Line Roller Bearing	RD 5843	Drive Gear Ratchet	RD 5898	Handle Screw Cap
RD 3339	Spool Support (B)	RD 5848	BaitRunner Pawl	RD 5899	Side Cover
RD 3340	Line Safety Guard Spacer	RD 5849	Spring Retainer	RD 5900	BaitRunner Lever Bridge
RD 4631	Spacer	RD 5850	BaitRunner Pawl Spring	RD 5901	BaitRunner Lever Arm (L)
RD 4718	Lever Spring Guide (A)	RD 5851	Worm Shaft Retainer	RD 5902	BaitRunner Lever Arm (R)
RD 4724	Ball Bearing	RD 5852	Dial Click	RD 5903	Rear Protector
RD 4743	Line Roller Bushing	RD 5853	BaitRunner Pawl Guide	RD 5904	Handle Assembly
RD 4744	Roller Bearing Seal	RD 5854	Oscillating Guide	RD 6003	Line Roller Washer
RD 4763	Roller Clutch Assembly	RD 5855	Oscillating Guide Holder	RD 6474	Spool Washer
RD 5040	Roller Clutch Screw	RD 5859	BaitRunner Lever Spacer	RD 6724	Idle Gear (B)
RD 5042	Anti-Reverse Cam Ring	RD 5860	Clutch Pawl Guard	RD 6726	Worm Shaft (B)
RD 5354	Line Roller	RD 5861	Clutch Lever	RD 6802	Bail Arm Bushing
RD 5677	Spool Support (A)	RD 5862	Clutch Pawl	RD 6813	Bail Arm
RD 5678	Bearing Retainer	RD 5863	Clutch Arm Cover	RD10981	Spacer
RD 5681	Angle Controller	RD 5864	Clutch Arm	RD13477	Bail Assembly
RD 5682	Bail Arm Nut	RD 5865	Clutch Pawl Spring	RD13478	Line Safety Guard
RD 5683	Spring Guide (A) Support	RD 5866	Push Nut (SPN-2)	RD14488	Spool Assembly
RD 5684	Bail Spring Guide (A)	RD 5867	Clutch Spring		